



PNEUMATIC COUPLINGS
PNEUMATISCHE KUPPLUNGEN

SERIE **026S**

DN **7.8**

Materials

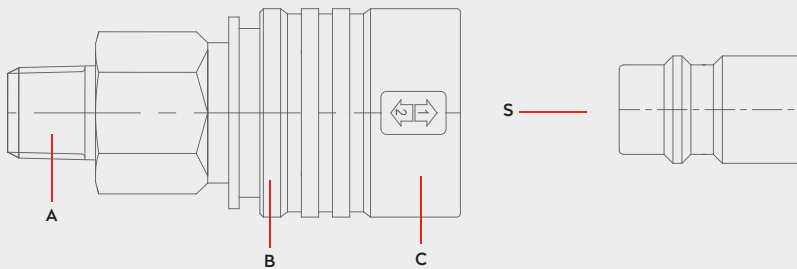

Material Code

A = Steel Zinc Plated

B = Plastic

C = Brass Nickel Plated

S = Steel Nickel Plated



0 - 12 bar
(0-174 PSI)



-20° to + 100°C (NBR)
-4° to + 212°F

Shut Off Type

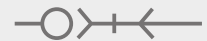

OM 200 - 00700
OM 100 - 01200
OM 200 - 00900
OM 178 - 00975

2 - STAGE

ISO 4414

DN

7.8 mm

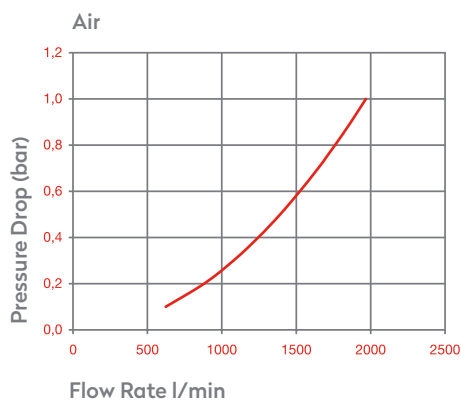

Options

Plug Profile Serie 026S

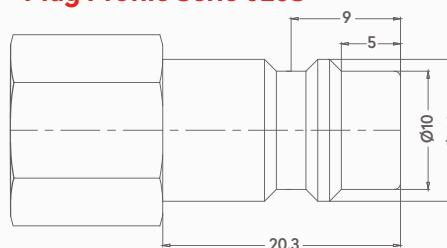

Compatible with

TST	025
PARKER - RECTUS	25, 26
CEJN	320

ISO 4414
Euro Profile - DN7.2

SERIE 026S



QUICK COUPLINGS SCHNELLKUPPLUNGEN

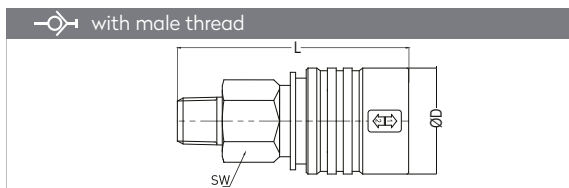

Connection	Part No.	SW	L	ØD
BSPT 1/4"	026 RGS 13	21	59,5	30
BSPT 3/8"	026 RGS 17	21	61	30
BSPT 1/2"	026 RGS 21	24	65	30
BSP 1/4"	026 EGS 13	21	56,5	30
BSP 3/8"	026 EGS 17	21	56,5	30
BSP 1/2"	026 EGS 21	24	59,5	30
NPT 1/4"	026 TGS 13	21	59,5	30
NPT 3/8"	026 TGS 17	21	61	30
NPT 1/2"	026 TGS 21	24	65	30

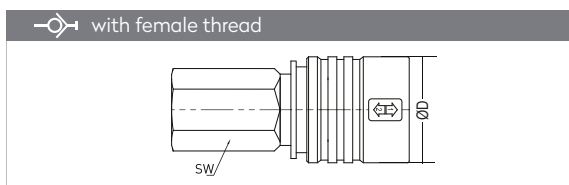

Connection	Part No.	SW	L	ØD
BSP 1/4"	026 DGS 13	21	60	30
BSP 3/8"	026 DGS 17	21	60	30
BSP 1/2"	026 DGS 21	24	62	30
NPT 1/4"	026 NGS 13	21	63	30
NPT 3/8"	026 NGS 17	21	64	30
NPT 1/2"	026 NGS 21	24	67	30

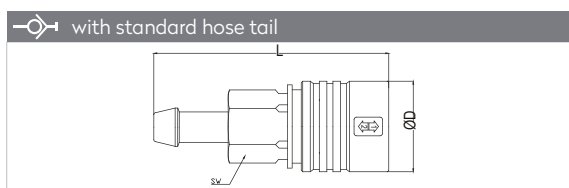

Connection	Part No.	SW	L	ØD
Ø 6 - 1/4"	026 HGS 06	21	72	30
Ø 8 - 5/16"	026 HGS 08	21	72	30
Ø 10 - 3/8"	026 HGS 10	21	72	30
Ø 13 - 1/2"	026 HGS 13	21	72	30

PLUGS STECKNIPPEL

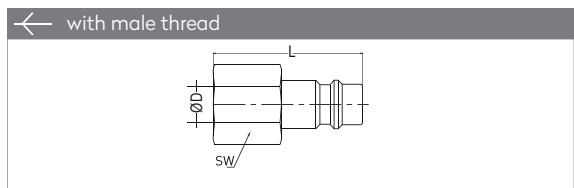

Connection	Part No.	SW	L
BSP 1/8"	026 DU 10	14	30
BSP 1/4"	026 DU 13	17	33
BSP 3/8"	026 DU 17	19	33
BSP 1/2"	026 DU 21	24	36
M 14 x 1,25	026 DUM 14 x 1,25	17	33
M 14 x 1,5	026 DUM 14	17	33
M 16 x 1,5	026 DUM 16	19	33
M 18 x 1,5	026 DUM 18	21	34

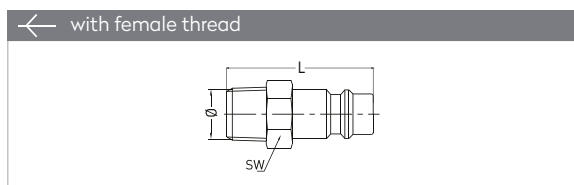

Connection	Part No.	SW	L
BSP 1/8"	026 EU 10	13	31
BSP 1/4"	026 EU 13	14	33
BSP 3/8"	026 EU 17	17	33
BSP 1/2"	026 EU 21	22	36
M 14 x 1,5	026 EUM 14	17	35
M 16 x 1,5	026 EUM 16	17	36
M 18 x 1,5	026 EUM 18	19	37

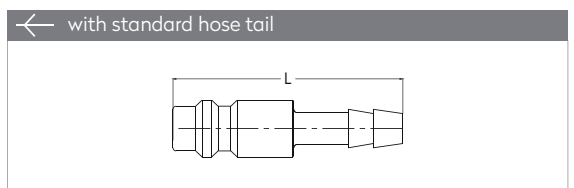

Connection	Part No.	L
6 mm - 1/4"	026 HU 06	46
8 mm - 5/16"	026 HU 08	46
9 mm - 5/14"	026 HU 09	46
10 mm - 3/8"	026 HU 10	46
13 mm - 1/2"	026 HU 13	48