



PNEUMATIC COUPLINGS
PNEUMATISCHE KUPPLUNGEN

SERIE **333**

DN 5-6



Materials

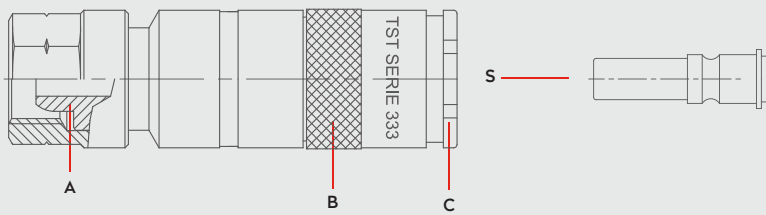

Material Code

A = Brass Chrome Plated

B = Brass Chrome Plated

C = Brass

S = Brass Chrome Plated



0 - 20bar
(0-290 PSI)



-20° to + 140°C (EPDM)
-4° to + 284°F

**Shut Off
Type**

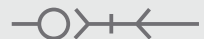

OE 240 - 00830
OE 200 - 01000

FLOW

150 lt/min

DN

5-6 mm

Plug Profile Serie 333

■ 333.05

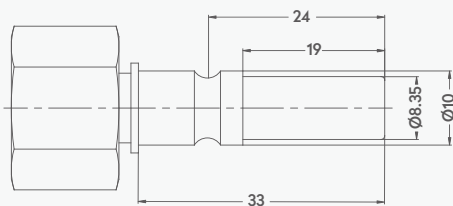

■ 333.06

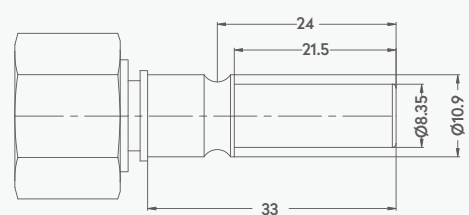

Options

Compatible with

IBEDA

QUICK COUPLINGS SCHNELLKUPPLUNGEN

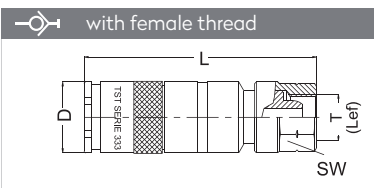

Connection	Part No.	SW	L	ØD
BSP 1/4"	333-05 DG 13-60	17	66,5	20
BSP 3/8"	333-05 DG 17-60	19	66,5	20
BSP 1/4"	333-06 DG 13-60	17	66,5	20
BSP 3/8"	333-06 DG 17-60	19	66,5	20

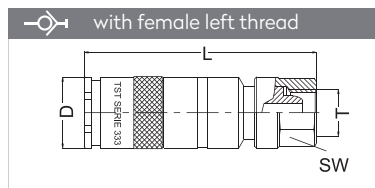

Connection	Part No.	SW	L	ØD
BSP 1/4"	333-05 LDG 13-60	17	66,5	20
BSP 3/8"	333-05 LDG 17-60	19	66,5	20
BSP 1/4"	333-06 LDG 13-60	17	66,5	20
BSP 3/8"	333-06 LDG 17-60	19	66,5	20

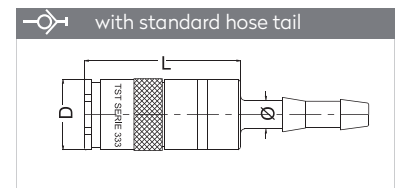

Connection	Part No.	L	ØD
Ø 7	333-05 HG 07	66,5	20
Ø 10	333-05 HG 10	66,5	20
Ø 7	333-06 HG 07	66,5	20
Ø 10	333-06 HG 10	66,5	20

PLUGS STECKNIPPEL

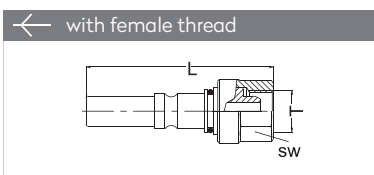

Connection	Part No.	SW	L	ØD
BSP 1/4"	333-05 DU 13-60	17	55	20
BSP 3/8"	333-05 DU 17-60	19	55	21
BSP 1/4"	333-06 DU 13-60	17	55	20
BSP 3/8"	333-06 DU 17-60	19	55	21

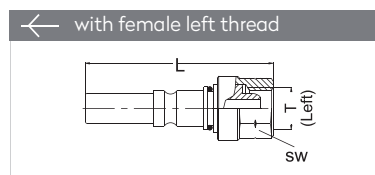

Connection	Part No.	SW	L	ØD
BSP 1/4"	333-05 LDU 13-60	17	55	20
BSP 3/8"	333-05 LDU 17-60	19	55	21
BSP 1/4"	333-06 LDU 13-60	17	55	20
BSP 3/8"	333-06 LDU 17-60	19	55	21

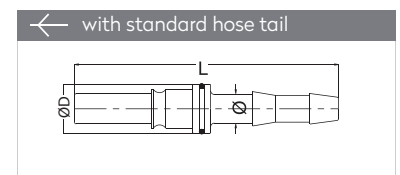

Connection	Part No.	L	ØD
Ø 7	333-05 HU 07	71,5	13,7
Ø 10	333-05 HU 10	71,5	13,7



PNEUMATIC COUPLINGS
PNEUMATISCHE KUPPLUNGEN

SERIE 334 DN 4.5-5

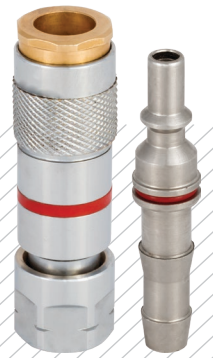

Materials

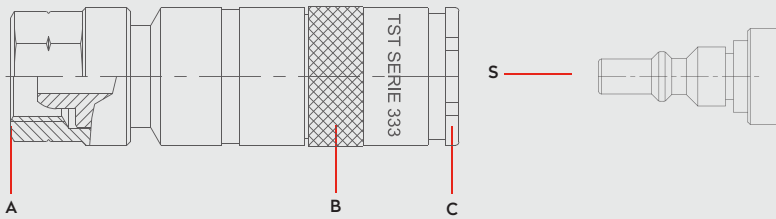

Material Code

A = Brass Chrome Plated

B = Brass Chrome Plated

C = Brass

S = Steel Nickel Plated



0 - 20bar
(0-290 PSI)



-20° to + 135°C (EPDM)
-4° to + 284°F

Shut Off
Type

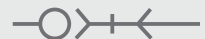

OE 200 - 01000
OE 200 - 00450
OE 178 - 00720

FLOW

150 lt/min

DN

4.5-5 mm

Plug Profile Serie 334

■ 334 - 4.5

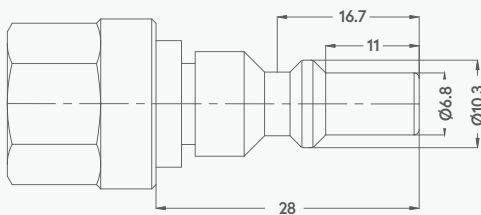

■ 334 - 0.5

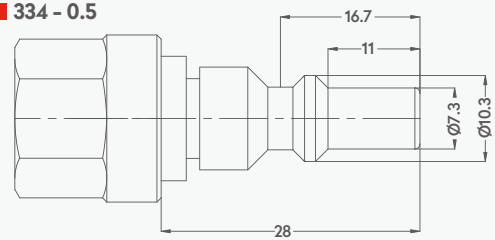

Options

Compatible with

IBEDA



QUICK COUPLINGS SCHNELLKUPPLUNGEN

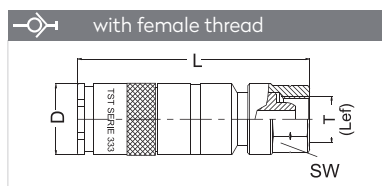

Connection	Part No.	SW	L	ØD
BSP 1/4"	334 -4.5 DG 13-60	17	70	20
BSP 3/8"	334 -4.5 DG 17-60	19	70	20
BSP 1/4"	334 -05 DG 13-60	17	70	20
BSP 3/8"	334 -05 DG 17-60	19	70	20

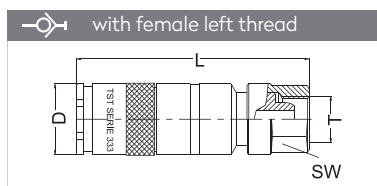

Connection	Part No.	SW	L	ØD
BSP 1/4"	334 -4.5 LDG 13-60	17	70	20
BSP 3/8"	334 -4.5 LDG 17-60	19	70	20
BSP 1/4"	334 -05 LDG 13-60	17	70	20
BSP 3/8"	334 -05 LDG 17-60	19	70	20

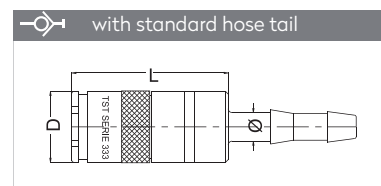

Connection	Part No.	L	ØD
Ø 7	334 -4.5 HG 07	82,8	20
Ø 10	334 -4.5 HG 10	82,8	20
Ø 7	334 -05 HG 07	82,8	20
Ø 10	334 -05 HG 10	82,8	20

PLUGS STECKNIPPEL

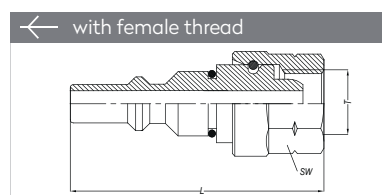

Connection	Part No.	SW	L
BSP 1/4"	334 -4.5 DU 13-60	17	48,5
BSP 3/8"	334 -4.5 DU 17-60	19	48,5
BSP 1/4"	334 -05 DU 13-60	17	48,5
BSP 3/8"	334 -05 DU 17-60	19	48,5

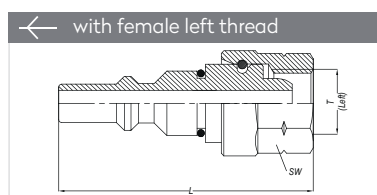

Connection	Part No.	SW	L
BSP 1/4"	334 -4.5 LDU 13-60	17	48,5
BSP 3/8"	334 -4.5 LDU 17-60	19	48,5
BSP 1/4"	334 -05 LDU 13-60	17	48,5
BSP 3/8"	334 -05 LDU 17-60	19	48,5

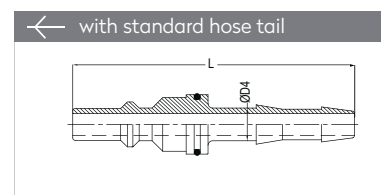

Connection	Part No.	L	ØD
Ø 7	334 -05 HU 07	64,5	13,7
Ø 10	334 -05 HU 10	64,5	13,7



PNEUMATIC COUPLINGS
PNEUMATISCHE KUPPLUNGEN

SERIE 334 DN 4.5-5

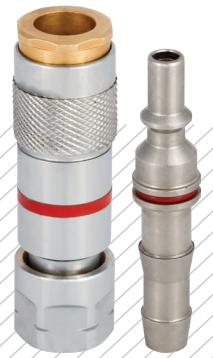

Materials

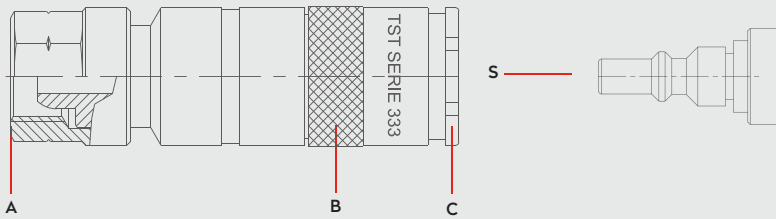

Material Code

A = Brass Chrome Plated

B = Brass Chrome Plated

C = Brass

S = Steel Nickel Plated



0 - 20bar
(0-290 PSI)



-20° to + 135°C (EPDM)
-4° to + 284°F

Shut Off
Type

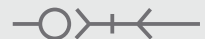

OE 200 - 01000
OE 200 - 00450
OE 178 - 00720

FLOW

150 lt/min

DN

4.5-5 mm

Plug Profile Serie 334

■ 334 - 4.5

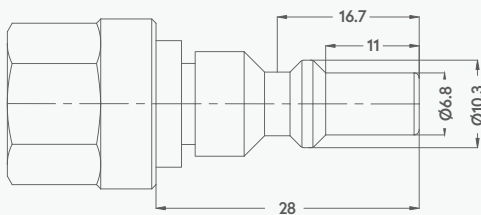

■ 334 - 0.5

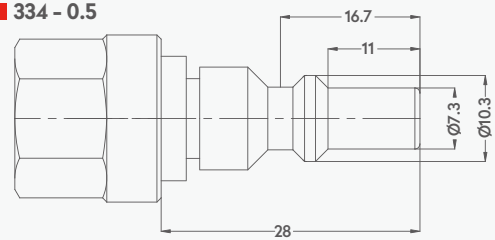

Options

Compatible with

IBEDA



QUICK COUPLINGS SCHNELLKUPPLUNGEN

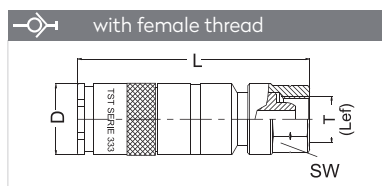

Connection	Part No.	SW	L	ØD
BSP 1/4"	334 -4.5 DG 13-60	17	70	20
BSP 3/8"	334 -4.5 DG 17-60	19	70	20
BSP 1/4"	334 -05 DG 13-60	17	70	20
BSP 3/8"	334 -05 DG 17-60	19	70	20

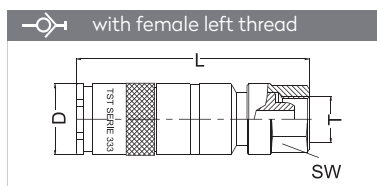

Connection	Part No.	SW	L	ØD
BSP 1/4"	334 -4.5 LDG 13-60	17	70	20
BSP 3/8"	334 -4.5 LDG 17-60	19	70	20
BSP 1/4"	334 -05 LDG 13-60	17	70	20
BSP 3/8"	334 -05 LDG 17-60	19	70	20

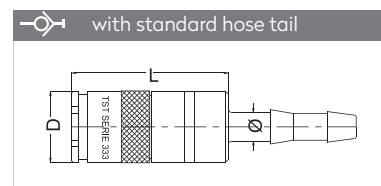

Connection	Part No.	L	ØD
Ø 7	334 -4.5 HG 07	82,8	20
Ø 10	334 -4.5 HG 10	82,8	20
Ø 7	334 -05 HG 07	82,8	20
Ø 10	334 -05 HG 10	82,8	20

PLUGS STECKNIPPEL

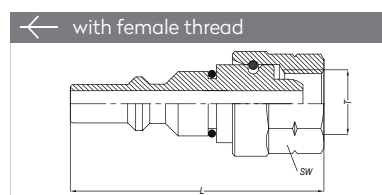

Connection	Part No.	SW	L
BSP 1/4"	334 -4.5 DU 13-60	17	48,5
BSP 3/8"	334 -4.5 DU 17-60	19	48,5
BSP 1/4"	334 -05 DU 13-60	17	48,5
BSP 3/8"	334 -05 DU 17-60	19	48,5

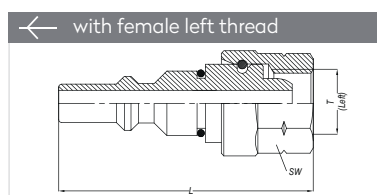

Connection	Part No.	SW	L
BSP 1/4"	334 -4.5 LDU 13-60	17	48,5
BSP 3/8"	334 -4.5 LDU 17-60	19	48,5
BSP 1/4"	334 -05 LDU 13-60	17	48,5
BSP 3/8"	334 -05 LDU 17-60	19	48,5

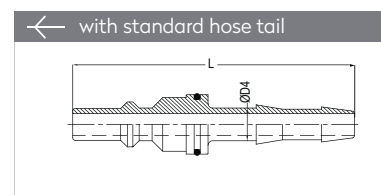

Connection	Part No.	L	ØD
Ø 7	334 -05 HU 07	64,5	13,7
Ø 10	334 -05 HU 10	64,5	13,7