

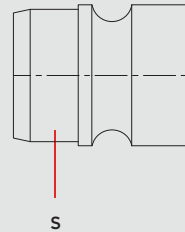

Materials

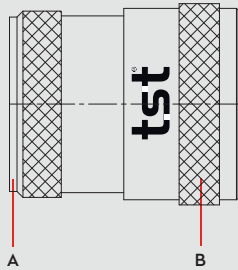

Material Code

- A = Brass Chrome Plated
- B = Brass Chrome Plated
- S = Brass Chrome Plated



0 - 35 bar



-40°C to + 105°C (NBR)

Shut Off Type



OM 262 - 01510  
CON - 1900 - 1400 - 20  
OM200 - 00800

FULL FLOW

DN

11 mm

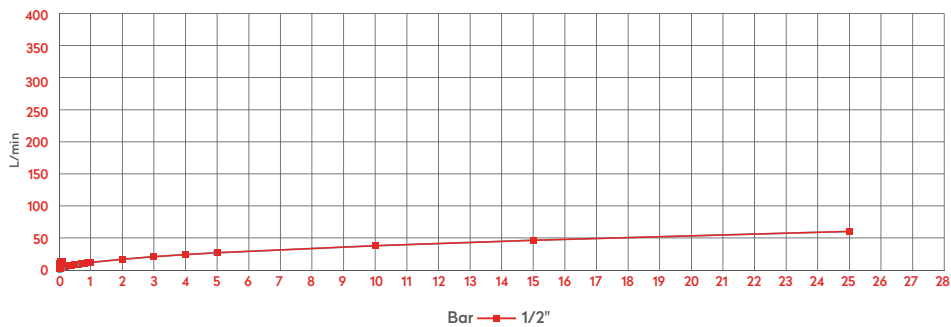

Options

FPM



AISI316  
Stainless Steel

Plug Profile Serie 110

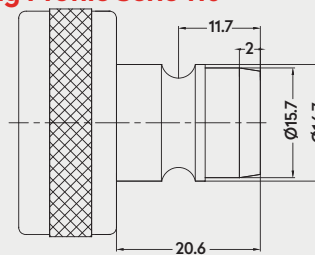

Compatible with

DYROS 100  
NITO 1/2" (5350)

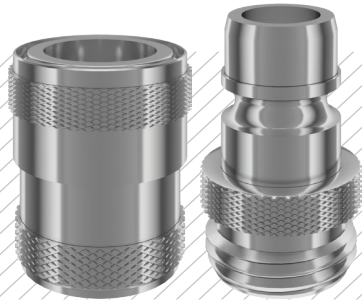

## QUICK COUPLINGS SCHNELLKUPPLUNGEN

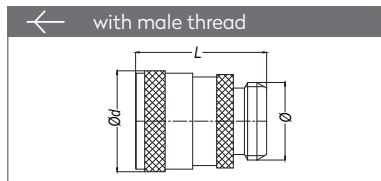

Part No.	Ø	Ød	L
110 EGF 17	BSP 3/8"	27.3	34.5
110 EGF 21	BSP 1/2"	27.3	35.5
110 EGF 26	BSP 3/4"	27.3	35.5
110 EGFM 22	M 22 x 1.5	27.3	35.5

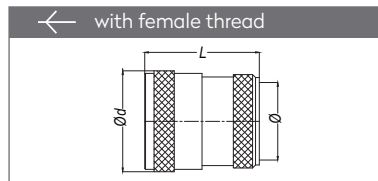

Part No.	Ø	Ød	L
110 DGF 17	BSP 3/8"	27.3	31
110 DGF 21	BSP 1/2"	27.3	31
110 DGF 26	BSP 3/4"	27.3	33
110 DGFM 22	M 22 x 1.5	27.3	31

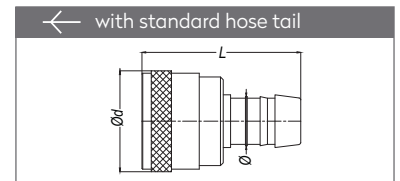

Part No.	Ø	Ød	L
110 HGF 10	Ø 10 mm - 3/8"	27.3	43
110 HGF 13	Ø 13 mm - 1/2"	27.3	43
110 HGF 16	Ø 16 mm - 5/8"	27.3	43
110 HGF 19	Ø 19 mm - 3/4"	27.3	43

## PLUGS STECKNIPPEL

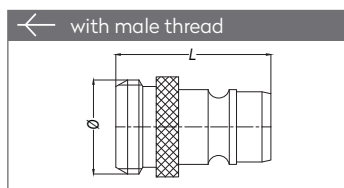

Part No.	Ø	L
110 EU 17	BSP 3/8"	34.6
110 EU 21	BSP 1/2"	34.6
110 EU 26	BSP 3/4"	34.6
110 EUM 22	M 22 x 1	34.6
110 EUM 24	M 24 x 1	37.6
110 EUM 28	M 28 x 1	37.6

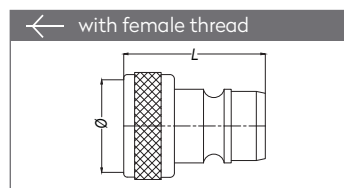

Part No.	Ø	L
110 DU 17	BSP 3/8"	30
110 DU 21	BSP 1/2"	32.1
110 DU 26	BSP 3/4"	33.6
110 DUM 22-1	M 22 x 1	30
110 DUM 24	M 24 x 1	31.6
110 DUM 22	M 22 x 1.5	32.1

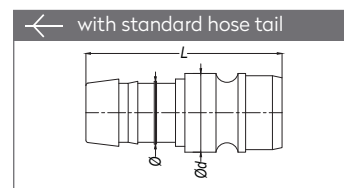

Part No.	Ø	Ød	L
110 HU 10	Ø 10 mm - 3/8"	16.7	41.6
110 HU 13	Ø 13 mm - 1/2"	16.7	41.6
110 HU 16	Ø 16 mm - 5/8"	17	41.6
110 HU 19	Ø 19 mm - 3/4"	20	41.6

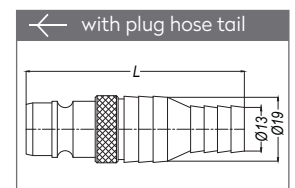

Part No.	Ø	L
110 HU 13/19	Ø 13 - Ø 19	65

## ACCESSORIES ZUBEHÖR

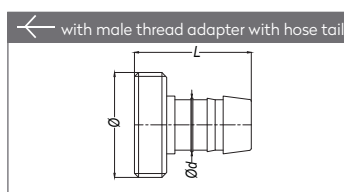

Part No.	Ø	Ød	L
110 GU 13	BSP 3/4"	Ø19	29
110 GU 19	BSP 3/4"	Ø19	29

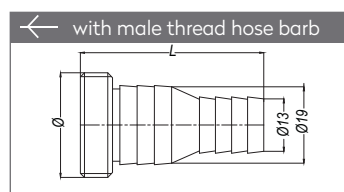

Part No.	Ø	Ød-Ød1	L
110 GU 13/19	BSP 3/4"	Ø13-19	45.6

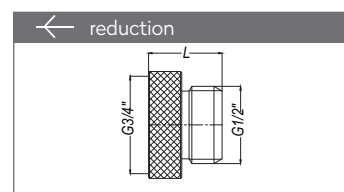

Part No.	Ø	L
110 RD 21	BSP 3/4" - 1/2"	20

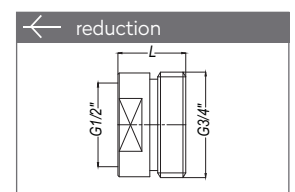

Part No.	Ø	L
110 RD 26	BSP 1/2" - 3/4"	17

## CHECK VALVE RÜCKSCHLAGVENTILE

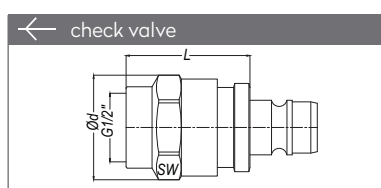

Part No.	Ø	Ød	L	SW
110 CVD 21	BSP 1/2"	32	37.9	30

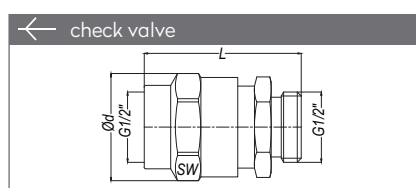

Part No.	Ø	Ød	L	SW
110 CVD 21 - E 21	BSP 1/2" - BSP 1/2"	32	47	30

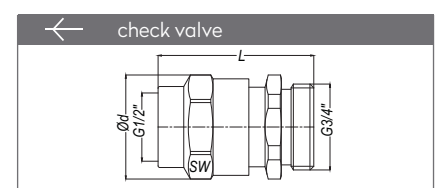

Part No.	Ø	Ød	L	SW
110 CVD 21 - E 26	BSP 3/4" - BSP 1/2"	32	47.9	30